



MEMORANDUM

301 W. MAIN ▪ OWOSSO, MICHIGAN 48867-2958 ▪ WWW.CI.OWOSSO.MI.US

DATE: January 15, 2020
TO: Owosso City Council
FROM: Glenn Chinavare, Director of Public Services & Utilities
SUBJECT: Setting Public Hearing for Special Assessment Roll for Summit Street Resurfacing

RECOMMENDATION:

Approval of Resolution No. 4, setting the second public hearing for Summit Street Resurfacing Project.

BACKGROUND:

This public hearing is intended to provide affected residents with the opportunity to comment regarding their individual assessments.

Step Four/Resolution No. 4 takes place after the bids are received. Estimated assessment amounts are adjusted if necessary to reflect the actual cost as dictated by the bids received. A second public hearing is set to allow property owners to comment on their particular assessment. Each property owner is sent a second notice containing the date and time of the public hearing and the amount of the proposed assessment for their property. City Council sets the second public hearing at its **January 21, 2020** meeting.

Step Five/Resolution No. 5 documents the second public hearing, finalizes the special assessment roll and sets the terms of payment. This public hearing is designed to allow affected citizens the opportunity to argue whether or not the amount of their assessment is fair and equitable in relation to the benefit they receive from the project. If, after hearing citizen comment, the council decides adjustments need to be made to the assessment roll they may do so. Alternately, if it is felt all the assessments are fair and equitable the resolution may be passed as written.

Tonight the council will be considering Resolution No. 4 for the proposed district as a part of the Consent Agenda. Staff recommends authorization of Resolution No. 4 setting a public hearing for Monday, **February 3, 2020** to receive citizen comment regarding the proposed special assessment roll for the following public improvement:

Summit Street, a Public Street, from Abbott Street to Rubelman Drive

Attachment(s): Summit Street Resolution No. 4
Summit Street Special Assessment Roll
Summit Street Special Assessment Roll

RESOLUTION NO.

**SPECIAL ASSESSMENT DISTRICT NO. 2020-04
SUMMIT STREET
FROM ABBOTT STREET TO RUBELMAN DRIVE
SPECIAL ASSESSMENT RESOLUTION NO. 4**

WHEREAS, the Assessor has prepared a special assessment roll for the purpose of specially assessing that portion of the cost of the public improvements more particularly hereinafter described to the properties specially benefited by said public improvement, and the same has been presented to the Council by the City Clerk.

NOW, THEREFORE, BE IT RESOLVED THAT:

1. Said special assessment roll is hereby accepted and shall be filed in the office of the City Clerk for public examination.
2. The Council shall meet at the Owosso City Hall, Owosso, Michigan at 7:30 o'clock p.m., on Monday, February 3, 2020 for the purpose of hearing all persons interested in said special assessment roll and reviewing the same.
3. The City Clerk is directed to publish the notice of said hearings once in the *Argus Press*, the official newspaper of the City of Owosso, not less than ten (10) days prior to said hearing and shall further cause notice of said hearing to be sent by first class mail to each owner of the property subject to assessment, as indicated by the records in the City Assessor's office as shown on the general tax rolls of the City, at least ten (10) days before the time of said hearing, said notice to be mailed to the addresses shown on said general tax rolls of the City.
4. The notice of said hearing to be published and mailed shall be in substantially the following form:

**NOTICE OF HEARING
TO REVIEW SPECIAL ASSESSMENT ROLL
CITY OF OWOSSO, COUNTY OF SHIAWASSEE, MICHIGAN**

TO THE OWNERS OF THE FOLLOWING DESCRIBED PROPERTY:

SUMMIT STREET, A PUBLIC STREET, FROM ABBOTT STREET TO RUBELMAN DRIVE

TAKE NOTICE that a Special Assessment roll has been prepared for the purpose of defraying the Special Assessment district's share of the cost of the following described improvements:

STREET RESURFACING

The said Special Assessment roll is on file for public examination with the City Clerk and any objections to said Special Assessment roll must be filed in writing with the City Clerk prior to the close of the hearing to review said Special Assessment roll.

TAKE FURTHER NOTICE that appearance and protest at this hearing is required in order to appeal the amount of the special assessment to the State Tax Tribunal if an appeal should be desired. A property owner or party in interest, his or her agent, may appear in person at the hearing to protest the special assessment or may file his or her appearance by letter and his or her personal appearance shall not be required. The property owner or any person having an interest in the property subject to the proposed special assessments may file a written appeal of the special assessment with the State Tax Tribunal within thirty days after confirmation of the special assessment roll if that special assessment was protested at this hearing.

TAKE FURTHER NOTICE that the City Council will meet at the Owosso City Hall, Owosso, Michigan at 7:30 p.m. on Monday, February 3, 2020 for the purpose of reviewing said special assessment roll and for the purpose of considering all objections to said roll submitted in writing.



City of Owosso

Proposed Special Assessment

Summit Street From Abbot St. to Rubelman Dr.



Legend

-  Summit Street Assessment Parcels
-  City Parcels 2018
- 501 Street Address Number

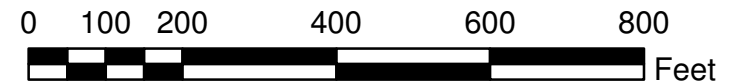

1 inch = 250 feet

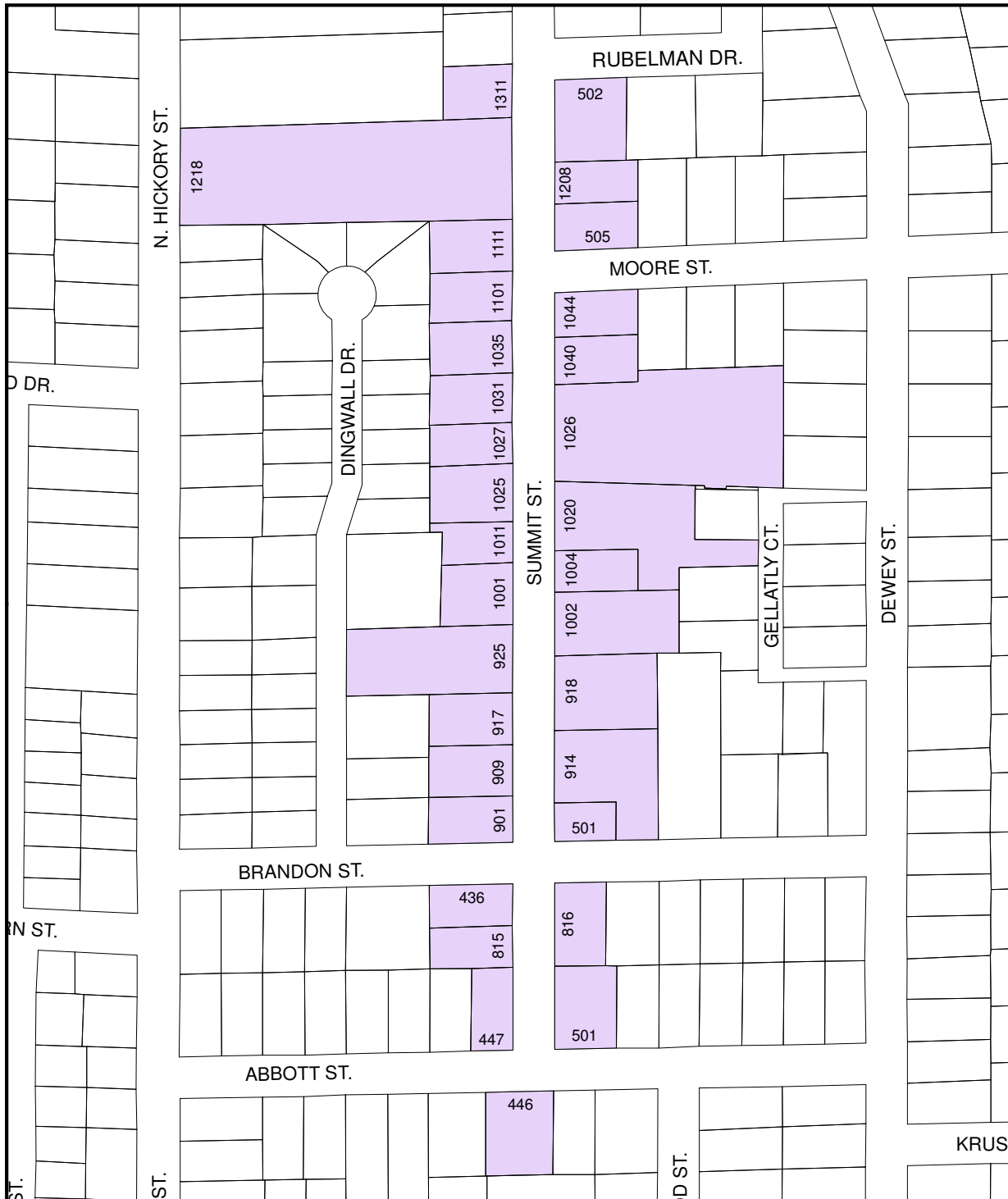

**POST BID ASSESSMENT CALCULATIONS
SUMMIT STREET**

SUMMIT STREET FROM ABBOTT TO RUBELMAN

SPECIAL ASSESSMENT ROLL NO. 2020-04

RESO 4

ENGINEER'S ESTIMATE ASSESSABLE AMOUNT	\$383,398.26
TOTAL ASSESSABLE FRONT FEET	2715.53

CALCULATING ASSESSABLE FRONT FOOT RATE AND AMOUNTS:

PROPERTY TYPE	RESIDENTIAL PROPERTY	COMMERCIAL PROPERTY	TOTAL
TOTAL ASSEMENT PER TYPE	\$383,398.26	\$383,398.26	
CITY SHARE $\geq 60\%$	\$276,865.28	\$262,989.57	
PROPERTY SHARE @ $\leq 40\%$	\$106,532.98	\$120,408.69	
ASSESSABLE FRONT FOOT RATE: PROP SHARE/2715.53	\$39.23	\$44.34	
TOTAL FRONT FEET PER TYPE	2715.53	0.00	
TOTAL AMOUNT OF ASSESSMENT PER TYPE:	\$106,532.98	\$0.00	\$106,532.98

SUMMARY: SPECIAL ASSESSMENT AMOUNTS PER SIDE OF STREET:

WEST SIDE	\$54,706.24
EAST SIDE	\$49,881.93
SOUTH SIDE (ABBOTT)	<u>\$1,941.89</u>
TOTAL SPECIAL ASSESSMENT	\$106,530.05

WEST SIDE

ADDRESS NO.	STREET	PROPERTY OWNER	ROLL NUMBER	FRONT FOOTAGE	CORNER LOT DISCOUNT	ASSESSABLE FRONT FEET	FRONT FOOT RATE	AMOUNT OF ASSESSMENT	PROPERTY TYPE
447	ABBOTT	HARRIS, HILLARY	150-000-012	132	0.75	99.00	\$39.23	\$3,883.77	R-1
815	SUMMIT	PALMER, CHAD E; O'DRISCOLL, SHANNON D	150-000-013	66	1	66.00	\$39.23	\$2,589.18	R-1
436	BRANDON	BRADDOCK, SHERYL K	150-000-014	66	0.75	49.50	\$39.23	\$1,941.89	R-1
901	SUMMIT	BORIS, KIMBERLY	541-000-037	75	0.75	56.25	\$39.23	\$2,206.69	R-1
909	SUMMIT	BENNETT, DAWN	541-000-039	82.5	1	82.50	\$39.23	\$3,236.48	R-1
917	SUMMIT	BROWN, JULIE A	541-000-035	82.5	1	82.50	\$39.23	\$3,236.48	R-1
925	SUMMIT	SPITLER, FRANCES & WARREN	541-000-036	90	1	90.00	\$39.23	\$3,530.70	R-1
1001	SUMMIT	ADAMS, DAVID & MARY	541-000-044	99	1	99.00	\$39.23	\$3,883.77	R-1
1011	SUMMIT	GRACE, REBECCA L; VOGL, NANCY JO	541-000-045	76	1	76.00	\$39.23	\$2,981.48	R-1
1025	SUMMIT	GUMBS, REBEKAH E	541-000-047	89	1	89.00	\$39.23	\$3,491.47	R-1
1027	SUMMIT	PRITCHETT, RHONDA S	541-000-048	66	1	66.00	\$39.23	\$2,589.18	R-1
1031	SUMMIT	TOMCZYK, SUZANNE S	541-000-053	82.5	1	82.50	\$39.23	\$3,236.48	R-1
1035	SUMMIT	ROBERTSON, C A & B F	541-000-054	82.5	1	82.50	\$39.23	\$3,236.48	R-1
1101	SUMMIT	COOPER, DALE L	541-000-059	82.5	1	82.50	\$39.23	\$3,236.48	R-1
1111	SUMMIT	GERBER, LILA L TRUST	541-000-058	82.5	1	82.50	\$39.23	\$3,236.48	R-1
1218	N. HICKORY	SEVENTH DAY ADVENTIST CHURCH	541-000-060	165	0.75	123.75	\$39.23	\$4,854.71	R-1
1311	SUMMIT	MICHALEC, JUDITH L	140-000-032	85	1	85.00	\$39.23	\$3,334.55	R-1
				1504		1394.50		\$54,706.24	

**ENGINEER'S ESTIMATE - POST BID
SUMMIT STREET**

15-Jan-20

RESO 4

SUMMIT ST FROM ABBOTT TO RUBELMAN ENGINEER'S ESTIMATE

DESCRIPTION	UNIT	QUANTITY	UNIT PRICE	AMOUNT	ELLIGIBLE AMOUNT	CITY COST 60 PERCENT	ASSESSMENT AT 40% RESIDENTIAL	ASSESSMENT AT 40% COMMERCIAL
Mobilization, Max \$85,500, (Road and Storm)	LSUM	0.40	\$ 85,500.00	\$ 34,200.00	\$ 34,200.00	\$ 20,520.00	\$ 13,680.00	\$ 13,680.00
Tree, Rem, 6 inch to 18 inch	EA		\$ 2,500.00	\$ -				
Dr Structure, Rem	EA	15.00	\$ 350.00	\$ 5,250.00		\$ -	\$ -	\$ -
Sewer, Rem, Less than 24 inch	FT	1108.00	\$ 3.00	\$ 3,324.00		\$ -	\$ -	\$ -
Sewer, Rem, 24 inch to 48 inch	FT		\$ 30.00	\$ -		\$ -	\$ -	\$ -
Curb and Gutter, Rem	FT	1070.00	\$ 4.50	\$ 4,815.00	\$ 4,815.00	\$ 2,889.00	\$ 1,926.00	\$ 1,926.00
Pavt, Rem	SYD	155.00	\$ 6.00	\$ 930.00	\$ 930.00	\$ 558.00	\$ 372.00	\$ 372.00
Sidewalk, Rem	SYD	325.00	\$ 5.00	\$ 1,625.00		\$ -	\$ -	\$ -
Embankment, CIP	CYD	65.00	\$ 8.00	\$ 520.00		\$ -	\$ -	\$ -
Excavation, Earth	CYD	1810.00	\$ 12.00	\$ 21,720.00		\$ -	\$ -	\$ -
Subbase, CIP	CYD	75.00	\$ 18.77	\$ 1,407.75		\$ -	\$ -	\$ -
Subgrade Undercutting, Type II	CYD	200.00	\$ 25.00	\$ 5,000.00		\$ -	\$ -	\$ -
Erosion Control, Inlet Protection, Fabric Drop	EA	16.00	\$ 80.00	\$ 1,280.00	\$ 1,280.00	\$ 768.00	\$ 512.00	\$ 512.00
Aggregate Base, 6 inch, Modified	SYD		\$ 10.45	\$ -		\$ -	\$ -	\$ -
Aggregate Base, 8 inch, Modified	SYD	6425.00	\$ 13.15	\$ 84,488.75	\$ 84,488.75	\$ 50,693.25	\$ -	\$ 6,336.66
Maintenance Gravel	TON	100.00	\$ 30.00	\$ 3,000.00	\$ 3,000.00	\$ 1,800.00	\$ 1,200.00	\$ 1,200.00
Geotextile, Separator	SYD	6425.00	\$ 2.00	\$ 12,850.00		\$ -	\$ -	\$ -
Sewer, SDR-26, 10 inch, Tr Det B, Modified	FT	254.00	\$ 60.00	\$ 15,240.00		\$ -	\$ -	\$ -
Sewer, SDR-26, 12 inch, Tr Det B, Modified	FT	384.00	\$ 67.00	\$ 25,728.00		\$ -	\$ -	\$ -
Sewer, SDR-26, 15 inch, Tr Det B, Modified	FT	413.00	\$ 72.00	\$ 29,736.00		\$ -	\$ -	\$ -
Sewer, SDR-26, 18 inch, Tr Det B, Modified	FT	37.00	\$ 83.00	\$ 3,071.00		\$ -	\$ -	\$ -
Sewer, SDR-26, 24 inch, Tr Det B, Modified	FT		\$ 112.00	\$ -		\$ -	\$ -	\$ -
Sewer Bulkhead, 12 inch	EA	5.00	\$ 100.00	\$ 500.00		\$ -	\$ -	\$ -
Sewer Tap, 12 inch	EA	1.00	\$ 400.00	\$ 400.00		\$ -	\$ -	\$ -
Sewer Tap, 18 inch	EA		\$ 500.00	\$ -		\$ -	\$ -	\$ -
Dr Structure, Temp Lowering	EA	7.00	\$ 200.00	\$ 1,400.00	\$ 1,400.00	\$ 840.00	\$ 560.00	\$ 560.00
Dr Structure Cover, Adj, Case 1	EA	7.00	\$ 450.00	\$ 3,150.00	\$ 3,150.00	\$ 1,890.00	\$ 1,260.00	\$ 1,260.00
Dr Structure, Tap, 12 inch	EA		\$ 350.00	\$ -		\$ -	\$ -	\$ -
Dr Structure Collar, Modified	EA		\$ 500.00	\$ -		\$ -	\$ -	\$ -
Dr Structure Cover, EJ 1040 w/ Vented Gasket Sealed Cover	EA	7.00	\$ 700.00	\$ 4,900.00	\$ 4,900.00	\$ 2,940.00	\$ 1,960.00	\$ 1,960.00
Dr Structure Cover, EJ 1040 w/ Solid Gasket Sealed Cover	EA	7.00	\$ 700.00	\$ 4,900.00	\$ 4,900.00	\$ 2,940.00	\$ 1,960.00	\$ 1,960.00
Dr Structure Cover, EJ 7000	EA	10.00	\$ 750.00	\$ 7,500.00	\$ 7,500.00	\$ 4,500.00	\$ 3,000.00	\$ 3,000.00
Dr Structure 36 inch dia, Modified	EA	10.00	\$ 1,500.00	\$ 15,000.00		\$ -	\$ -	\$ -
Dr Structure 48 inch dia, Modified	EA	5.00	\$ 2,000.00	\$ 10,000.00		\$ -	\$ -	\$ -
Dr Structure 60 inch dia, Modified	EA	2.00	\$ 3,000.00	\$ 6,000.00		\$ -	\$ -	\$ -
Dr Structure 72 inch dia, Modified	EA		\$ 3,500.00	\$ -		\$ -	\$ -	\$ -

**ENGINEER'S ESTIMATE - POST BID
SUMMIT STREET**

SUMMIT ST FROM ABBOTT TO RUBELMAN ENGINEER'S ESTIMATE

DESCRIPTION	UNIT	QUANTITY	UNIT PRICE	AMOUNT	ELIGIBLE AMOUNT	CITY COST 60 PERCENT	ASSESSMENT AT 40% RESIDENTIAL	ASSESSMENT AT 40% COMMERCIAL
HMA Surface, Rem	SYD	6425.00	\$ 2.00	\$ 12,850.00	\$ 12,850.00	\$ 7,710.00	\$ 5,140.00	\$ 5,140.00
Hand Patching	TON	10.00	\$ 130.30	\$ 1,303.00	\$ 1,303.00	\$ 781.80	\$ 521.20	\$ 521.20
HMA, 3E3 @ 3.0"	TON	1158.00	\$ 67.70	\$ 78,396.60	\$ 78,396.60	\$ 47,037.96	\$ 26,132.20	\$ 31,358.64
HMA, 4E3 @ 2.0"	TON		\$ 85.90	\$ -		\$ -	\$ -	\$ -
HMA, 5E3 @ 1.5"	TON	579.00	\$ 92.80	\$ 53,731.20	\$ 53,731.20	\$ 32,238.72	\$ 21,492.48	\$ 21,492.48
HMA Approach	TON	10.00	\$ 103.40	\$ 1,034.00	\$ 1,034.00	\$ 620.40	\$ 413.60	\$ 413.60
Cement	TON	2.00	\$ 175.00	\$ 350.00		\$ -	\$ -	\$ -
Saw Cutting	FT	100.00	\$ 4.00	\$ 400.00		\$ -	\$ -	\$ -
Driveway, Nonreinf Conc, 6 inch	SYD	125.00	\$ 28.00	\$ 3,500.00		\$ -	\$ -	\$ -
Driveway, Nonreinf Conc, 9 inch	SYD		\$ 41.00	\$ -		\$ -	\$ -	\$ -
Approach, CI II, LM	CYD	10.00	\$ 50.00	\$ 500.00	\$ 500.00	\$ 300.00	\$ 200.00	\$ 200.00
Curb and Gutter, Conc, Det F4	FT		\$ 13.50	\$ -		\$ -	\$ -	\$ -
Curb and Gutter, Conc, Det F4, Modified	FT	1070.00	\$ 16.00	\$ 17,120.00	\$ 17,120.00	\$ 10,272.00	\$ 6,848.00	\$ 6,848.00
Driveway Opening, Conc, Det M	FT		\$ 16.00	\$ -		\$ -	\$ -	\$ -
Detectable Warning Surface, Modified	FT	115.00	\$ 68.00	\$ 7,820.00		\$ -	\$ -	\$ -
Sidewalk Ramp, Conc, 7 inch	SFT	1815.00	\$ 5.15	\$ 9,347.25		\$ -	\$ -	\$ -
Sidewalk, Conc, 4 inch	SFT	990.00	\$ 3.15	\$ 3,118.50		\$ -	\$ -	\$ -
Sidewalk, Conc, 6 inch	SFT	300.00	\$ 3.35	\$ 1,005.00		\$ -	\$ -	\$ -
Sidewalk, Conc, 9 inch	SFT		\$ 4.15	\$ -		\$ -	\$ -	\$ -
Valve Box, Adj	EA	4.00	\$ 250.00	\$ 1,000.00		\$ -	\$ -	\$ -
Sanitary Serv Conflict	EA	2.00	\$ 1,000.00	\$ 2,000.00		\$ -	\$ -	\$ -
Abandoned Gas Main Conflict	EA	5.00	\$ 200.00	\$ 1,000.00		\$ -	\$ -	\$ -
Barricade, Type III, High Intensity, Double Sided, Furn & Oper	EA	9.00	\$ 90.00	\$ 810.00		\$ -	\$ -	\$ -
Pedestrian Type II Barricade, Temp	EA	10.00	\$ 100.00	\$ 1,000.00		\$ -	\$ -	\$ -
Lighted Arrow, Type C, Furn & Oper	EA	1.00	\$ 350.00	\$ 350.00		\$ -	\$ -	\$ -
Minor Traf Devices	LSUM	0.40	\$ 10,000.00	\$ 4,000.00	\$ 4,000.00	\$ 2,400.00	\$ 1,600.00	\$ 1,600.00
Plastic Drum, High Intensity, Furn & Oper	EA	30.00	\$ 16.50	\$ 495.00		\$ -	\$ -	\$ -
Sign, Type B, Temp, Prismatic, Furn & Oper	SFT	177.00	\$ 3.45	\$ 610.65		\$ -	\$ -	\$ -
Sign, Portable, Changeable Message, Furn & Oper	EA		\$ 2,150.00	\$ -		\$ -	\$ -	\$ -
Turf Establishment, Performance	SYD	1200.00	\$ 4.75	\$ 5,700.00		\$ -	\$ -	\$ -
Post, Steel, 3lb	FT		\$ 7.50	\$ -		\$ -	\$ -	\$ -
Sign, Type III, Erect, Salv	EA		\$ 60.00	\$ -		\$ -	\$ -	\$ -
Sign, Type III, Rem	EA		\$ 40.00	\$ -		\$ -	\$ -	\$ -
Sign, Type IIIB	SFT		\$ 17.25	\$ -		\$ -	\$ -	\$ -
Sign, Type V, Rem	EA		\$ 45.00	\$ -		\$ -	\$ -	\$ -
Sign, Type VB	SFT		\$ 24.50	\$ -		\$ -	\$ -	\$ -
Pavt Mrkg, Ovly Cold Plastic, 6 inch, Crosswalk	FT		\$ 2.50	\$ -		\$ -	\$ -	\$ -

**ENGINEER'S ESTIMATE - POST BID
SUMMIT STREET**

SUMMIT ST FROM ABBOTT TO RUBELMAN ENGINEER'S ESTIMATE

DESCRIPTION	UNIT	QUANTITY	UNIT PRICE	AMOUNT	ELIGIBLE AMOUNT	CITY COST 60 PERCENT	ASSESSMENT AT 40% RESIDENTIAL	ASSESSMENT AT 40% COMMERCIAL
Pavt Mrkg, Ovly Cold Plastic, 24 inch, Stop Bar	FT		\$ 11.00	\$ -		\$ -	\$ -	\$ -
Pavt Mrkg, Ovly Cold Plastic, Rt Turn Arrow Sym	EA		\$ 140.00	\$ -		\$ -	\$ -	\$ -
Pavt Mrkg, Ovly Cold Plastic, Thru and Lt Turn Arrow Sym	EA		\$ 170.00	\$ -		\$ -	\$ -	\$ -
Pavt Mrkg, Waterborne, 4 inch, White	FT		\$ 0.29	\$ -		\$ -	\$ -	\$ -
Pavt Mrkg, Waterborne, 4 inch, Yellow	FT		\$ 0.29	\$ -		\$ -	\$ -	\$ -
Post, Mailbox	EA		\$ 100.00	\$ -		\$ -	\$ -	\$ -
Audio Visual Filming	LSUM	0.40	\$ 6,000.00	\$ 2,400.00		\$ -	\$ -	\$ -
SUB TOTALS				\$ 517,776.70	\$ 319,498.55	\$ 191,699.13	\$ 88,777.48	\$ 100,340.58
ENGINEERING AT 15% ASSESSABLE COST				\$ 77,666.51	\$ 47,924.78	\$ 28,754.87	\$ 13,316.62	\$ 15,051.09
ADMINISTRATIVE AT 5% ASSESSABLE COST				\$ 25,888.84	\$ 15,974.93	\$ 9,584.96	\$ 4,438.87	\$ 5,017.03
GRAND TOTALS				\$ 621,332.04	\$ 383,398.26	\$ 230,038.96	\$ 106,532.98	\$ 120,408.69